

grid  
seem® 4

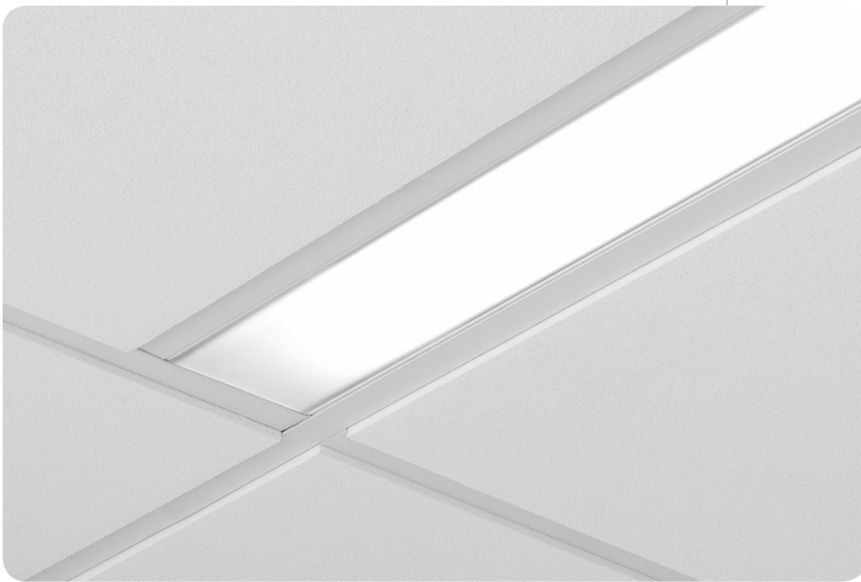

features

Narrow 4" aperture slot fluorescent luminaire that integrates with the ceiling for a clean unobtrusive aesthetic.

Frosted acrylic flush lens provides even illumination, high performance lens available for increased efficiency. Parabolic louver also available.

Allows for individual and continuous row mount in grid applications.

Available in 1 lamp T5, T5H0 or T8 and 2 lamp T5 or T8 configurations, Seem 4 provides continuous illumination by combining 3' and 4' staggered lamps. Specify 1 lamp for even appearance and minimal lamp image, or 2 lamps when higher light levels are required.

dimensional data

row mount T5/T5H0/T8

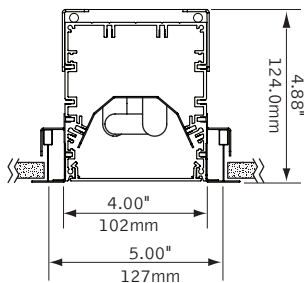

individual T8

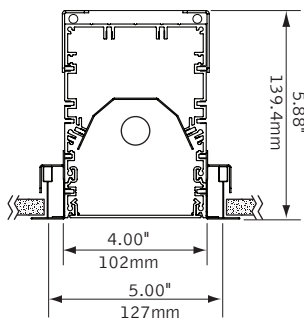

individual T5/T5H0

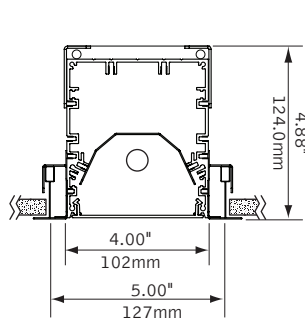

shielding options

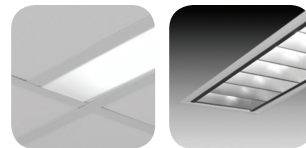

lens

companion luminaires



wall to ceiling corner

suspended

wall mount

performance

1-Lamp T5	1-Lamp T5
High Performance Lens	Flush Satin Lens
77% Efficiency	56% Efficiency
999 cd @ 0°	595 cd @ 0°

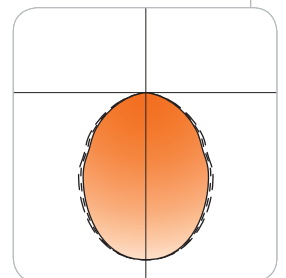

Visit [focalpointlights.com](http://focalpointlights.com) for complete photometric data.

fixture:

project:

### mounting information

#### grid

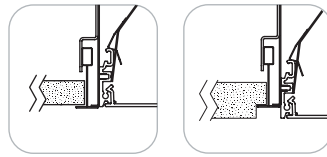
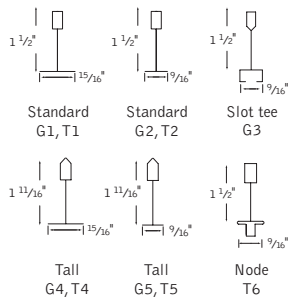

lay-in tile (G)      tegular tile (T)  
Luminaire always rests at level of tile.

### specifications

#### construction

One piece, .07" thick housing of 6063-T5 extruded aluminum.  
20 Ga. steel end caps.  
Luminaires include 22 Ga. steel, .35" wide flange rail finished in Matte Satin White.

Earthquake brackets standard on all luminaires.  
Lengths 6' and longer configured with staggered lamps  
(6' & 8' T8 configured with non-staggered lamps):

1-lamp T8:	4.47" overlap
2-lamp T8:	9.35" overlap
1-lamp T5/T5HO:	4.35" overlap
2-lamp T5:	2.00" overlap

2' unit weight:	18 lbs.
3' unit weight:	24 lbs.
4' unit weight:	30 lbs.
5' unit weight:	36 lbs.
6' unit weight:	43 lbs.
8' unit weight:	55 lbs.

#### optic

Reflectors fabricated of 22 Ga. steel finished in High Reflectance White powder coat.  
Flush satin lens: extruded acrylic lens .07" thick with opal satin finish.  
High performance flush lens: extruded acrylic lens .07" thick with increased light transmission.  
Parabolic Louver: 0.75"H x 1.5" frequency fabricated of low iridescent semi-specular premium grade aluminum.

#### electrical

Luminaires are pre-wired with factory installed branch circuit wiring and over-molded quick connects.  
Electronic fluorescent ballasts are thermally protected and have a Class "P" rating.  
Optional dimming ballasts available.  
UL and cUL listed.

#### finish

Polyester powder coat applied over a 5-stage pre-treatment.

### ordering

luminaire series FSM4

Seem 4 FSM4

shielding \_\_\_\_\_

Flush Satin Lens FL  
High Performance Flush Lens (lamp image may be visible) FLXP  
Parabolic Louver PL

lamping \_\_\_\_\_

One Lamp T8 1T8  
Two Lamp T8 2T8  
One Lamp T5 1T5  
Two Lamp T5 2T5  
One Lamp T5HO 1T5HO

circuits \_\_\_\_\_

Single Circuit 1C  
Dual Circuit 2C  
(2-lamp luminaires only)

voltage \_\_\_\_\_

120 Volt 120  
277 Volt 277  
347 Volt 347

ballast \_\_\_\_\_

Electronic Instant Start <20% THD (T8 only) E  
Electronic Program Start <10% THD S  
Electronic Dimming Ballast\* D

ceiling configurations \_\_\_\_\_

Std. 15/16" Lay-in G1  
Std. 15/16" Tegular T1  
Std. 9/16" Lay-in G2  
Std. 9/16" Tegular T2  
9/16" Slot-tee Tegular G3  
Tall 15/16" Lay-in G4  
Tall 15/16" Tegular (not available in T8 individuals) T4  
Tall 9/16" Lay-in G5  
Tall 9/16" Tegular (not available in T8 individuals) T5  
Node 9/16" Tegular T6

factory options \_\_\_\_\_

Chicago Plenum CP  
Emergency Circuit\* EC  
Emergency Battery Pack\* EM  
Flex Whip\* FW  
HLR/GLR Fuse FU  
Include 3000K lamp L830  
Include 3500K lamp L835  
Include 4100K lamp L841

finish WH

Matte White WH

luminaire length \_\_\_\_\_

(designed to fit standard grid lengths)  
Specify luminaire/row length in 1' increments X'  
(lengths 6' and longer configured with staggered lamps. 6' 2-lamp T8 configured with non-staggered lamps, row mount not available)

Focal Point LLC | 41.41 S. Pulaski Rd, Chicago, IL 60632 | T: 773.247.9494 | F: 773.247.8484 | info@focalpointlights.com | www.focalpointlights.com. Focal Point LLC reserves the right to change specifications for product improvement without notification.

\* for more information see Reference section.

# seem™ 4



Filename: FSM4FLXP1T5.IES  
 Catalog #: FSM4-FLXP-1T5-1C-120-S-G1-WH-4'  
 Efficiency: 77%  
 Test #: 15712.0

## CANDLEPOWER DISTRIBUTION

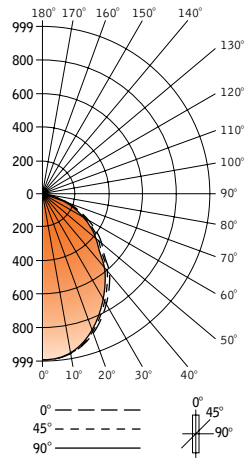

Spacing 1.1  
 Criterion: 1.1

Vertical Angle	Horizontal Angle				Zonal Lumens
	0°	22.5°	45°	67.5°	
0°	999	999	999	999	999
5°	997	996	994	994	994
15°	942	941	937	93	931
25°	831	827	817	806	802
35°	692	685	670	654	648
45°	510	503	484	466	458
55°	378	373	355	338	333
65°	236	23	219	210	205
75°	118	116	111	105	103
85°	31	29	28	28	31
90°	0	0	0	0	0
95°	0	0	0	0	0
105°	0	0	0	0	0
115°	0	0	0	0	0
125°	0	0	0	0	0
135°	0	0	0	0	0
145°	0	0	0	0	0
155°	0	0	0	0	0
165°	0	0	0	0	0
175°	0	0	0	0	0
180°	0	0	0	0	0

## LUMEN SUMMARY

	Zone Lumens	% Lamp	% Fixt
0°-30°	738	25.5	33.3
0°-40°	1159	40.0	52.2
0°-60°	1853	63.9	83.5
0°-90°	2220	76.6	100
<b>Total Luminaire</b>	<b>2220</b>	<b>76.6</b>	<b>100</b>

## LUMINANCE DATA (CD/M<sup>2</sup>)

Vertical Angle	0°	45°	90°
45°	6091	5781	5470
55°	5566	5227	4903
65°	4716	7376	4097
75°	3850	3622	3361
85°	3004	2713	2713

## CO-EFFICIENTS OF UTILIZATION

Floor	80	70	20	30	10	00
Ceiling	80	70	50	50	10	00
Wall	70 50 30 10	70 50 10	50 10	50 10	50 10	00
RCR 0	91 91 91 91	89 89 89	85 85	81 81	78 78	77
1	85 81 78 76	82 80 75	76 72	73 70	71 68	67
2	78 72 68 64	76 71 63	68 62	66 60	64 59	58
3	72 65 59 55	70 64 54	61 53	59 53	58 52	50
4	66 58 52 47	65 57 47	55 46	54 46	52 45	44
5	61 52 46 41	59 51 41	49 40	48 40	47 39	38
6	56 47 40 36	55 46 36	45 35	44 35	42 35	33
7	52 42 35 32	51 42 32	41 31	40 31	39 31	29
8	48 38 32 8	47 38 28	37 27	36 27	35 27	26
9	45 35 28 24	43 34 24	33 24	32 24	32 24	22
10	41 31 26 22	40 31 22	30 21	30 21	29 21	20

Numbers indicate percentage values of reflectivity.

Go to [www.focalpointlights.com](http://www.focalpointlights.com) for additional photometric data.

# seem™ 4



Filename: FSM4FL1T5.IES  
 Catalog #: FSM4-FL-1T5-1C-120-S-G1-WH-4'  
 Efficiency: 56%  
 Test #: 15711.0

## CANDLEPOWER DISTRIBUTION

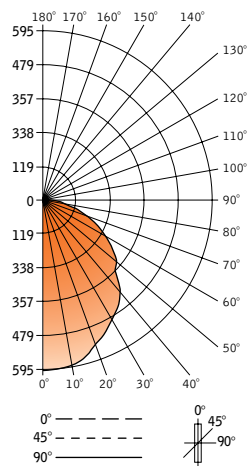

Spacing 1.2  
 Criterion: 1.2

Vertical Angle	Horizontal Angle				Zonal Lumens
	0°	22.5°	45°	67.5°	
0°	595	595	595	595	595
5°	591	591	591	591	591
15°	568	568	568	568	568
25°	515	515	515	515	515
35°	455	455	455	455	455
45°	353	355	355	355	355
55°	288	288	288	290	290
65°	198	196	198	198	199
75°	108	109	109	109	109
85°	28	28	28	28	29
90°	0	0	0	0	0
95°	0	0	0	0	0
105°	0	0	0	0	0
115°	0	0	0	0	0
125°	0	0	0	0	0
135°	0	0	0	0	0
145°	0	0	0	0	0
155°	0	0	0	0	0
165°	0	0	0	0	0
175°	0	0	0	0	0
180°	0	0	0	0	0

## LUMEN SUMMARY

	Zone Lumens	% Lamp	% Fixt
0°-30°	456	15.7	28.2
0°-40°	742	25.6	45.9
0°-60°	1275	44.0	78.9
0°-90°	1617	55.8	100
<b>Total Luminaire</b>	<b>1617</b>	<b>55.8</b>	<b>100</b>

## LUMINANCE DATA (CD/M<sup>2</sup>)

Vertical Angle	0°	45°	90°
45°	4216	4240	4240
55°	4241	4241	4270
65°	3957	3957	3977
75°	3524	3557	3557
85°	2713	2713	2810

## CO-EFFICIENTS OF UTILIZATION

Floor	80	70	20	30	10	00
Ceiling	80	70	50	50	10	00
Wall	70 50 30 10	70 50 10	50 10	50 10	50 10	00
RCR 0	66 66 66 66	65 65 65	62 62	59 59	57 57	56
1	61 59 56 54	60 57 53	55 52	53 50	51 49	48
2	56 52 48 45	54 51 44	49 43	47 42	45 41	40
3	51 46 41 38	50 45 38	43 37	42 36	40 36	35
4	47 41 36 32	46 40 32	39 32	37 31	36 31	30
5	43 36 31 27	42 35 27	34 27	33 27	32 26	25
6	40 32 27 24	39 32 24	31 23	30 23	29 23	22
7	36 29 24 21	36 29 21	28 21	27 20	26 20	19
8	34 26 21 18	33 26 18	25 18	24 18	24 18	17
9	31 23 19 16	30 23 16	22 15	22 15	21 15	14
10	29 21 17 14	28 21 14	20 14	20 14	19 14	13

Numbers indicate percentage values of reflectivity.

Go to [www.focalpointlights.com](http://www.focalpointlights.com) for additional photometric data.

# seem™ 4



Filename: FSM4FLXP2T5.IES  
 Catalog #: FSM4-FLXP-2T5-1C-120-S-G1-WH-4'  
 Efficiency: 65%  
 Test #: 15716.0

## CANDLEPOWER DISTRIBUTION

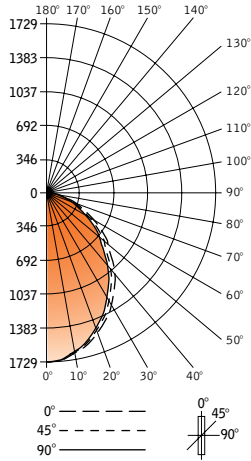

Spacing 1.1  
 Criterion: 1.1

Vertical Angle	0°	22.5°	45°	67.5°	90°	Zonal Lumens
0°	1729	1729	1729	1729	1729	
5°	1718	1716	1714	1714	1712	164
15°	1600	1594	1583	1573	1569	449
25°	1422	1411	1384	1359	1349	641
35°	1182	1165	1128	1093	1080	709
45°	891	871	832	796	781	656
55°	654	639	604	575	562	544
65°	407	397	374	355	347	373
75°	203	200	188	180	176	200
85°	56	55	52	51	49	57
90°	0	0	0	0	0	0
95°	0	0	0	0	0	0
105°	0	0	0	0	0	0
115°	0	0	0	0	0	0
125°	0	0	0	0	0	0
135°	0	0	0	0	0	0
145°	0	0	0	0	0	0
155°	0	0	0	0	0	0
165°	0	0	0	0	0	0
175°	0	0	0	0	0	0
180°	0	0	0	0	0	0

## LUMEN SUMMARY

Zone	Lumens	% Lamp	% Fixt
0°-30°	1254	21.6	33.1
0°-40°	1963	33.8	51.9
0°-60°	3153	54.4	83.3
0°-90°	3784	65.2	100
<b>Total Luminaire</b>	<b>3784</b>	<b>65.2</b>	<b>100</b>

## LUMINANCE DATA (CD/M<sup>2</sup>)

Vertical Angle	0°	45°	90°
45°	10642	9937	9328
55°	9630	8893	8275
65°	8133	7474	6934
75°	6624	6135	5743
85°	5426	5039	4748

## CO-EFFICIENTS OF UTILIZATION

Floor	80	70	50	30	10	00
RCR 0	78	78	78	78	78	78
1	72	69	67	65	63	60
2	66	62	58	54	56	51
3	61	55	50	47	52	45
4	56	49	44	40	47	40
5	52	44	39	35	42	34
6	48	40	34	31	38	30
7	44	36	31	27	35	27
8	41	33	27	24	31	23
9	38	29	24	21	28	20
10	35	27	22	18	26	18

Numbers indicate percentage values of reflectivity.

Go to [www.focalpointlights.com](http://www.focalpointlights.com) for additional photometric data.

# seem™ 4



Filename: FSM4FL2T5.IES  
 Catalog #: FSM4-FL-2T5-1C-120-S-G1-WH-4'  
 Efficiency: 47%  
 Test #: 15715.0

## CANDLEPOWER DISTRIBUTION

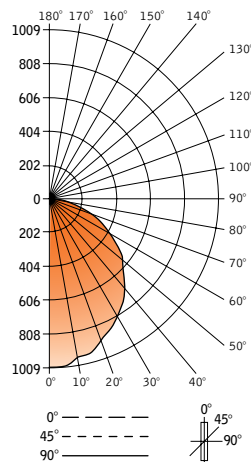

Spacing 1.2  
 Criterion: 1.2

Vertical Angle	0°	22.5°	45°	67.5°	90°	Zonal Lumens
0°	1009	1009	1009	1009	1009	
5°	1008	1006	1006	1006	1006	96
15°	954	952	952	952	952	270
25°	863	862	862	863	863	399
35°	759	761	761	761	759	478
45°	607	606	607	607	607	470
55°	488	488	489	491	491	439
65°	336	336	339	340	340	336
75°	181	183	184	184	184	194
85°	51	51	51	52	53	56
90°	0	0	0	0	0	0
95°	0	0	0	0	0	0
105°	0	0	0	0	0	0
115°	0	0	0	0	0	0
125°	0	0	0	0	0	0
135°	0	0	0	0	0	0
145°	0	0	0	0	0	0
155°	0	0	0	0	0	0
165°	0	0	0	0	0	0
175°	0	0	0	0	0	0
180°	0	0	0	0	0	0

## LUMEN SUMMARY

Zone	Lumens	% Lamp	% Fixt
0°-30°	765	13.2	27.9
0°-40°	1243	21.4	45.4
0°-60°	2152	37.1	78.6
0°-90°	2738	47.2	100
<b>Total Luminaire</b>	<b>2738</b>	<b>47.2</b>	<b>100</b>

## LUMINANCE DATA (CD/M<sup>2</sup>)

Vertical Angle	0°	45°	90°
45°	7250	7250	7250
55°	7185	7200	7230
65°	6714	6774	6794
75°	5906	6004	6004
85°	4942	4942	5136

## CO-EFFICIENTS OF UTILIZATION

Floor	80	70	50	30	10	00
RCR 0	56	56	56	56	56	56
1	52	50	48	46	50	44
2	47	44	41	38	41	37
3	43	39	35	32	37	31
4	40	34	30	27	33	27
5	36	30	26	23	29	23
6	33	27	23	20	26	20
7	31	24	20	17	23	17
8	28	22	18	15	21	15
9	26	20	16	13	19	13
10	24	18	14	12	17	11

Numbers indicate percentage values of reflectivity.

Go to [www.focalpointlights.com](http://www.focalpointlights.com) for additional photometric data.

# seem® 4 & 6 recessed run information

## EXAMPLE 16' run



### 1-T5/T5H0

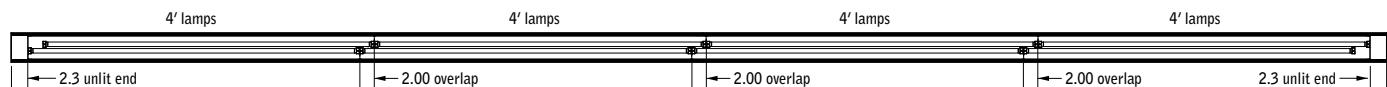

2-T5/T5H0 (may exhibit noticeable socket shadows)

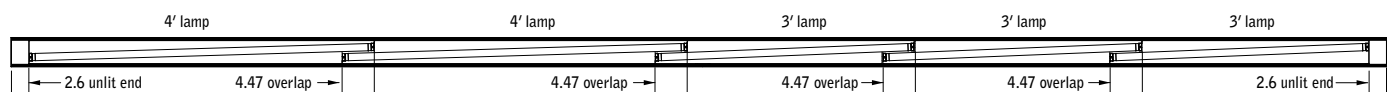

### 1-T8

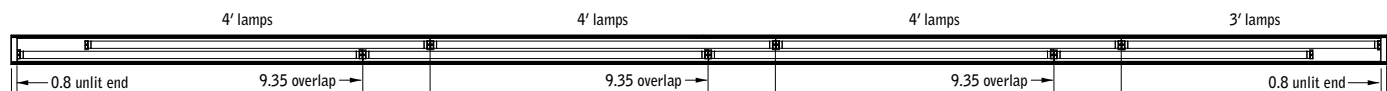

2-T8 (may exhibit noticeable socket shadows)

### notes:

- lamp overlap is consistent throughout run.
- unlit ends vary to provide even light throughout run.
- standard configurations listed, consult factory for additional options.
- 2T5H0 not available with Seem 4

# seem® 4 & 6 recessed run information

nominal run length (ft)	1-T5/T5HO (4.35" overlap)			2-T5/T5HO (2.00" overlap)			1-T8 (4.47" overlap)			2-T8 (9.35" overlap)		
	lamp quantity		unlit ends (in)	lamp quantity		unlit ends (in)	lamp quantity		unlit ends (in)	lamp quantity		unlit ends (in)
	3'	4'		3'	4'		3'	4'		3'	4'	
6		2	0.3*	4		0.2	2		1.8	n/a	n/a	n/a
7	1	1	3.6	2	2	0.3	1	1	1.8	4		0.8
8	3		0.5		4	0.4		2	1.8	2	2	0.8
9	2	1	0.6	6		1.1	3		4.0		4	0.9
10	1	2	0.6	4	2	1.2	2	1	4.1	6		0.8
11		3	0.8	2	4	1.3	4		0.3	4	2	0.8
12	2	2	0.3*		6	1.3	3	1	0.3	2	4	0.8
13	5		0.7	6	2	2.1	2	2	0.3		6	0.8
14	4	1	0.8	4	4	2.2	1	3	0.3	6	2	0.8
15	3	2	0.8	2	6	2.3		4	0.3	4	4	0.8
16	2	3	1.0		8	2.3	3	2	2.6	2	6	0.8
17	1	4	1.1	6	4	3.0	2	3	2.6		8	0.8
18		5	1.1	4	6	3.1	1	4	2.6	6	4	0.8
19	6	1	0.8	2	8	3.2	7		1.0	4	6	0.8
20	5	2	0.8		10	3.3	6	1	1.0	2	8	0.8
21	4	3	1.0	6	6	4.0	5	2	1.1		10	0.8
22	3	4	1.1	4	8	4.1	4	3	1.1	6	6	0.8
23	9		1.1	2	10	4.2	3	4	1.1	4	8	0.8
24	1	6	0.9		12	4.3	2	5	1.1	2	10	0.8
25	7	2	1.3	6	8	4.9	1	6	1.1		12	0.8
26	6	3	1.2	18		0.3		7	1.2	6	8	0.8
27	5	4	1.3	16	2	0.3	10		1.8	4	10	0.8
28	11		1.0	14	4	0.4	9	1	1.8	2	12	0.8
29	10	1	1.1	12	6	0.6	8	2	1.8		14	0.8
30	9	2	1.2	10	8	0.7	7	3	1.8	6	10	0.8
31	8	3	1.3		16	0.2	6	4	1.8	4	12	0.8
32	7	4	1.4	6	12	0.8	5	5	1.8	2	14	0.8
33	13		1.2	4	14	0.9	4	6	1.8		16	0.8
34	12	1	1.2	2	16	1.1	3	7	1.9	6	12	0.8
35	11	2	1.3		18	1.1	2	8	1.9	4	14	0.8
36	10	3	1.4	6	14	1.8	1	9	1.9	2	16	0.8
37	9	4	1.5	4	16	1.9	7	5	0.3		18	0.9
38	15		1.3	2	18	2.0	6	6	0.3	6	14	0.8
39	14	1	1.3		20	2.1	5	7	0.4	4	16	0.8
40	13	2	1.4	6	16	2.8	4	8	0.4	2	18	0.8
41	12	3	1.6	4	18	2.8	3	9	0.4		20	0.9
42	4	11	1.7	2	20	2.9	2	10	0.4	6	16	0.8
43	5	10	1.8		22	3.1	1	11	0.4	4	18	0.9
44	9	6	1.9	6	18	3.7		12	0.4	2	20	0.9
45	8	7	1.9	4	20	3.8	3	10	2.7		22	0.9
46	7	8	2.1	2	22	3.9	2	11	2.7	6	18	0.9
47	13	4	1.8		24	4.0	1	12	2.7	4	20	0.9
48	19		1.5	6	20	4.6	7	8	1.1	2	22	0.9

\* special lamp stagger to decrease end darkness.  
note: 2T5HO not available with Seem 4